

PT. CHEHALIS DISPOSAL SITE (FY19 HOPPER O&M DREDGING)

US Army Corps
of Engineers
Seattle District

MARCH 2019

SOUTH JETTY DISPOSAL SITE (SJDS)

STATIC CAPACITY:
- SJDS: TO -44' MLLW: N/A

DYNAMIC CAPACITY
- SJDS: 2 x STATIC: N/A

POINT CHEHALIS DISPOSAL SITE (PCDS)

STATIC CAPACITY
- PCDS TARGET TO -50' MLLW: 820,400 CY

DYNAMIC CAPACITY:
- PCDS: 2x the static capacity: 1.6 MCY

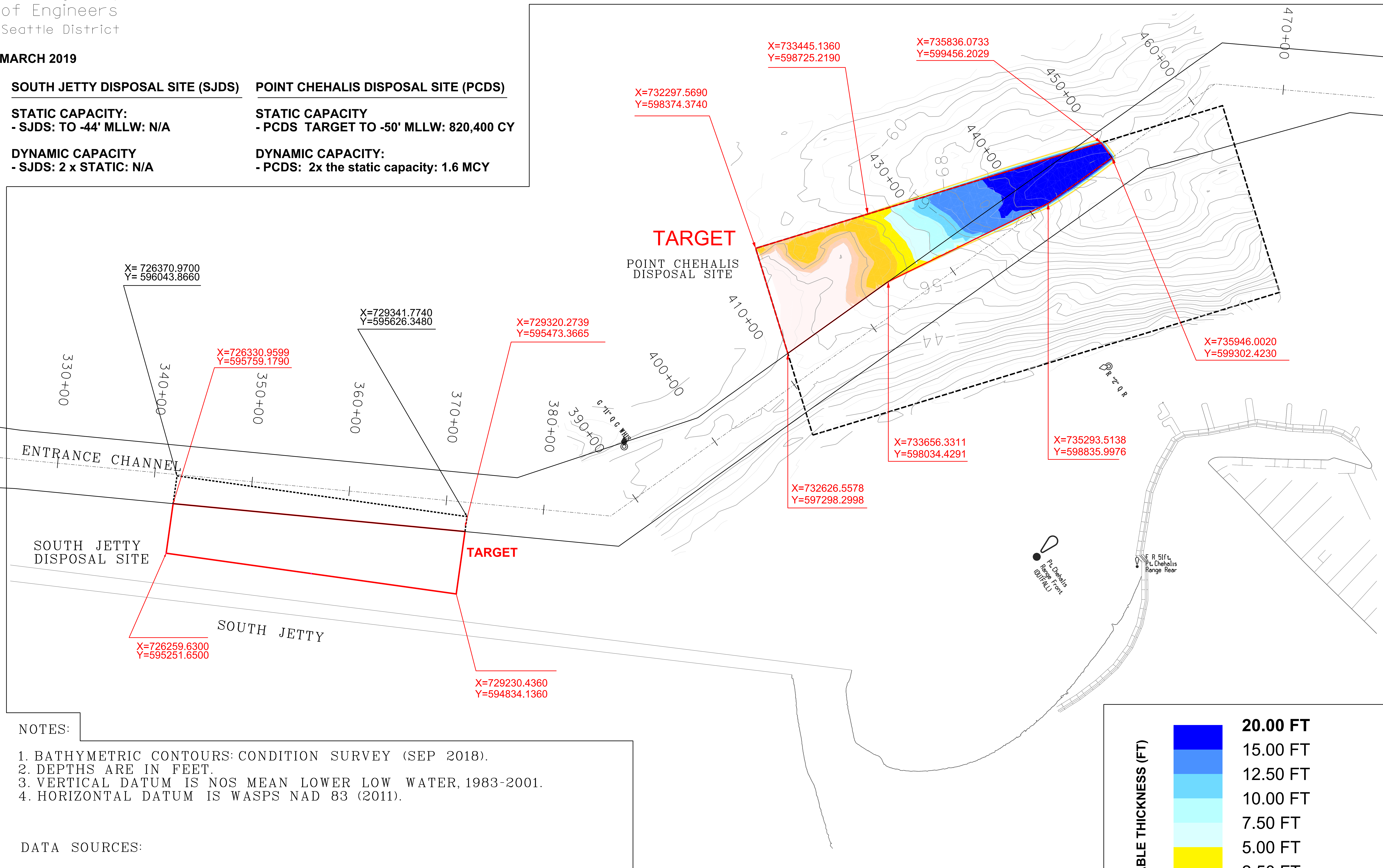

NOTES:

1. BATHYMETRIC CONTOURS: CONDITION SURVEY (SEP 2018).
2. DEPTHS ARE IN FEET.
3. VERTICAL DATUM IS NOS MEAN LOWER LOW WATER, 1983-2001.
4. HORIZONTAL DATUM IS WASPS NAD 83 (2011).

DATA SOURCES:

PCDS CONDITION SURVEY - 14 SEP 2018 (2018gr092.xyz)
 SJDS CONDITION SURVEY -

